

TEE

Forming Type:	1/2"-16" Cold Inner Expand 18"-48" Hot Press Forming.
Size:	Seamless Fittings 1/2"-16"(DN15-DN400); Welded Fittings 1/2"-48"(DN15-DN1200)
Standard:	ASME B16.9, MSS SP-43 , DIN 2615, JIS B2313 , GB/T12459, GB/T13401,SH3408, SH3409,HG/T21635 ,HG/T21631
Wall Thickness:	SCH5S-SCH160
Material:	Stainless Steel, Nickel Copper, Carbon Steel, Low Alloy Steel, Alloy Steel.

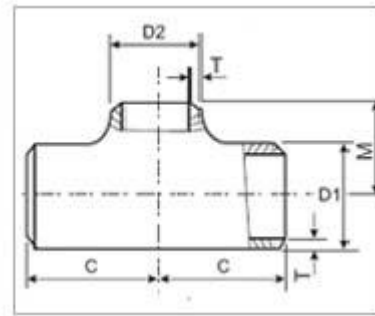
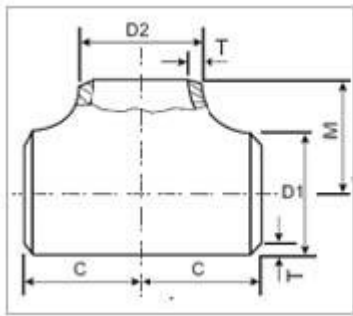

Nominal Diameter		Outside Diameter		Center to End	
		D1	D2	C	M
15×15×15	1/2×1/2×1/2	21.3	21.3	25	25
15×15×10	1/2×1/2×3/8	21.3	17.3	25	25
15×15×8	1/2×1/2×1/4	21.3	13.7	25	25
20×20×20	3/4×3/4×3/4	26.9	26.9	29	29
20×20×15	3/4×3/4×1/2	26.9	21.3	29	29
20×20×10	3/4×3/4×3/8	26.9	17.3	29	29

25×25×25	1×1×1	33.7	33.7	38	38
25×25×20	1×1×3/4	33.7	26.9	38	38
25×25×15	1×1×1/2	33.7	21.3	38	38
32×32×32	1.1/4×1.1/4×1.1/4	42.4	42.4	48	48
32×32×25	1.1/4×1.1/4×1	42.4	33.7	48	48
32×32×20	1.1/4×1.1/4×3/4	42.4	26.9	48	48
40×40×40	1.1/2×1.1/2×1.1/2	48.3	48.3	57	57
40×40×32	1.1/2×1.1/2×1.1/4	48.3	42.4	57	57
40×40×25	1.1/2×1.1/2×1	48.3	33.7	57	57
40×40×20	1.1/2×1.1/2×3/4	48.3	26.9	57	57
50×50×50	2×2×2	60.3	60.3	64	64
50×50×40	2×2×1.1/2	60.3	48.3	64	60
50×50×32	2×2×1.1/4	60.3	42.4	64	57
65×65×65	2.1/2×2/1/2×2.1/2	73	73	76	76
65×65×50	2.1/2×2/1/2×2	73	60.3	76	70
65×65×40	2.1/2×2/1/2×1.1/2	73	48.3	76	67
80×80×80	3×3×3	88.9	88.9	86	86
80×80×65	3×3×2.1/2	88.9	73	86	83
80×80×50	3×3×2	88.9	60.3	86	76
100×100×100	4×4×4	114.3	114.3	105	105

100×100×80	4×4×3	114.3	88.9	105	98
100×100×50	4×4×2	114.3	60.3	105	89
125×125×125	5×5×5	141.3	141.3	124	124
125×125×100	5×5×4	141.3	114.3	124	117
125×125×80	5×5×3	141.3	88.9	124	111
150×150×150	6×6×6	168.3	168.3	143	143
150×150×125	6×6×5	168.3	141.3	143	137
150×150×100	6×6×4	168.3	114.3	143	130
150×150×80	6×6×3	168.3	88.9	143	124
150×150×65	6×6×2.1/2	168.3	73	143	121
200×200×200	8×8×8	219.1	219.1	178	178
, , 200×200×150	8×8×6	219.1	168.3	178	168
200×200×125	8×8×5	219.1	141.4	178	162
250×250×250	10×10×10	273	273	216	216

Provide By [ZhiTong pipe fittings](#)